

## HEOS App Network Shares Setup Procedure

With the release of the latest HEOS App you will now see a new option in the HEOS App called “Network Shares”

### What Does The Network Shares Function Do?

Network Shares will allow the user to access music files (including iTunes music) from a PC or Apple Mac making the music files accessible from the HEOS App.

### Procedure to access the “Network Shares” option setup:

1. Open the HEOS App and go to Music > Settings.
2. Select “Music Sources”.
3. Select “Network Shares”.

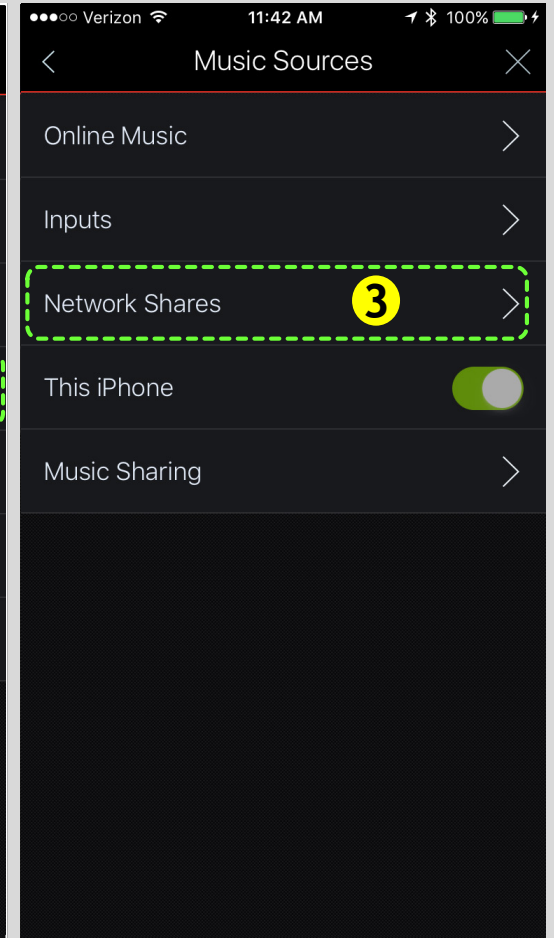
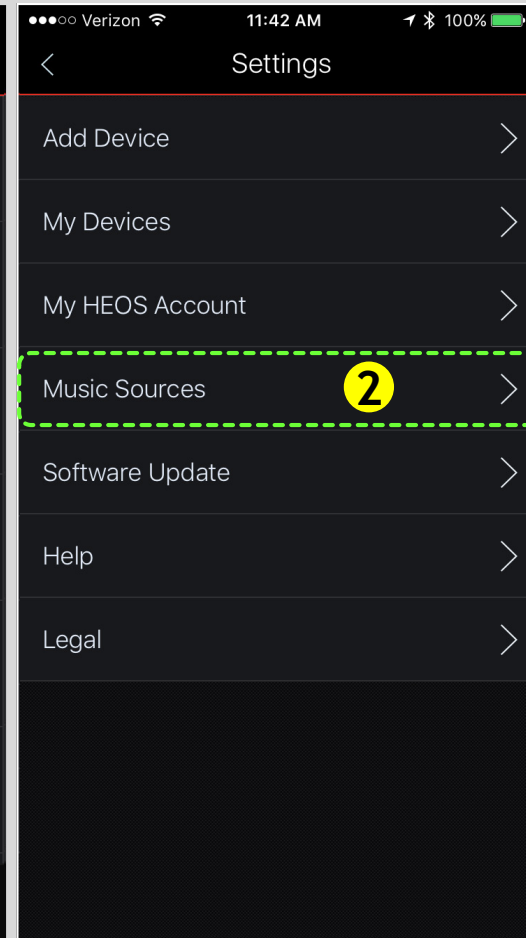
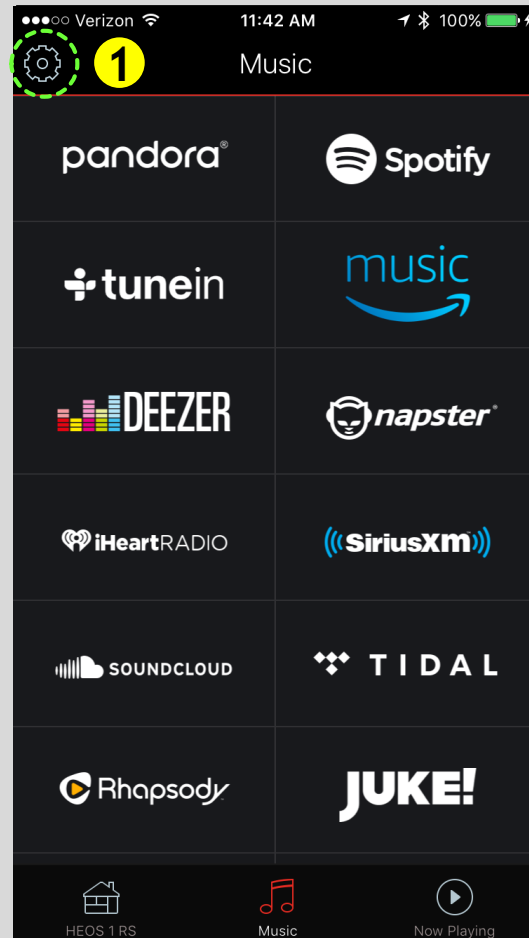

## HEOS App Network Shares Setup Procedure

### Procedure to access the “Network Shares” option setup:

4. Tap “**Add Share**” when the Add Share option appears.
5. You will now see the available HEOS devices where the share can be configured. Select the HEOS device to add the share
6. The “**Add Share**” screen appears.
  - a. Enter the Share Name (optional).
  - b. Enter the location of the music folder.
  - c. Enter the computer's user name.
  - d. Enter the password for the PC or Mac computer.
  - e. Tap the check mark.

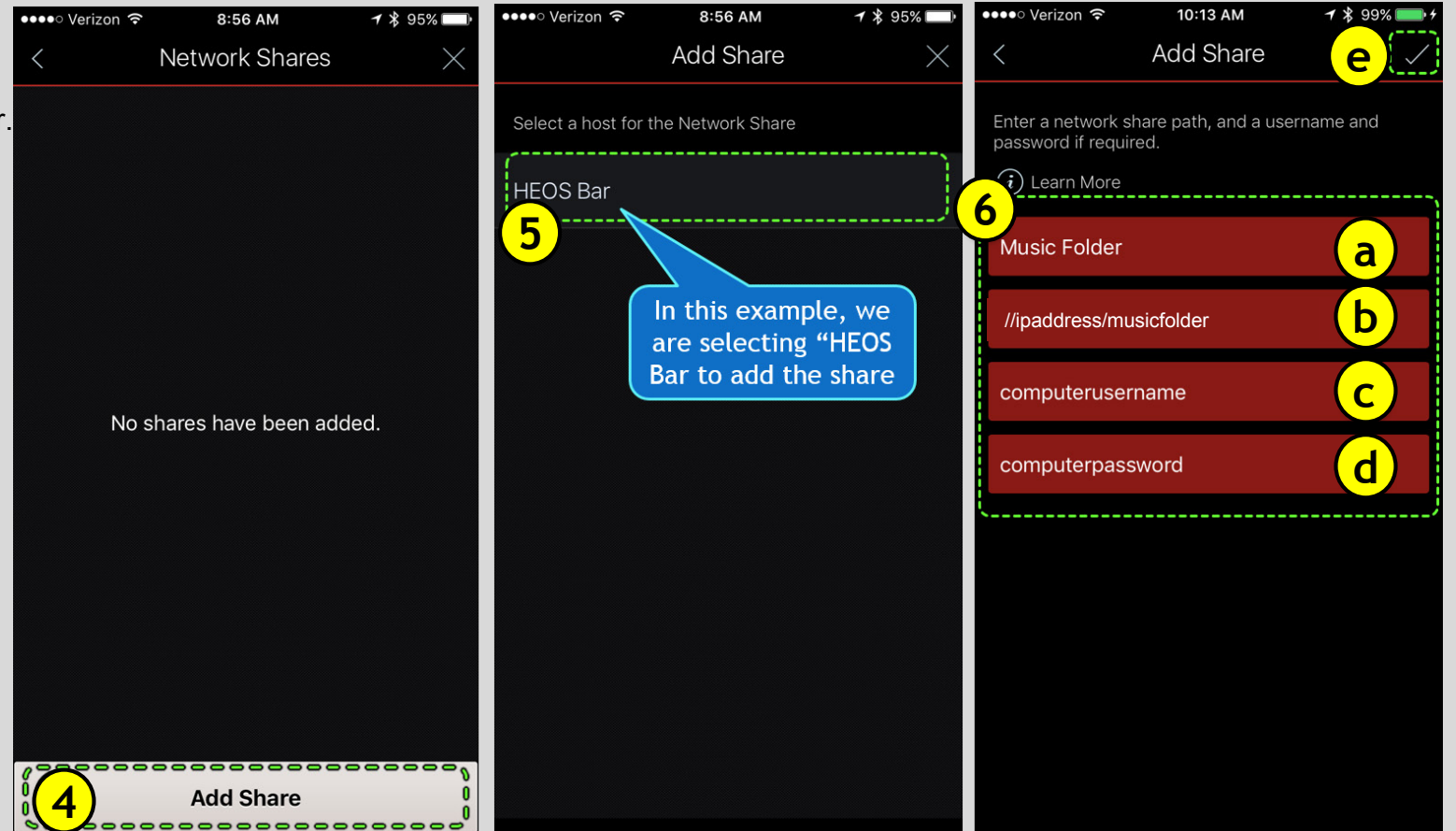

## HEOS App Network Shares Setup Procedure

### Procedure to access the “Network Shares” option setup:

7. The “**Network Shares**” screen appears showing the “**Music Folder**” share name. Click the “**X**” in the upper right of the screen.
8. From the Music tab select the “**Music Servers**” option.
9. From “**Music Servers**” you will now see the “**Music Folder**” network share name. Select the “**Music Folder**”.

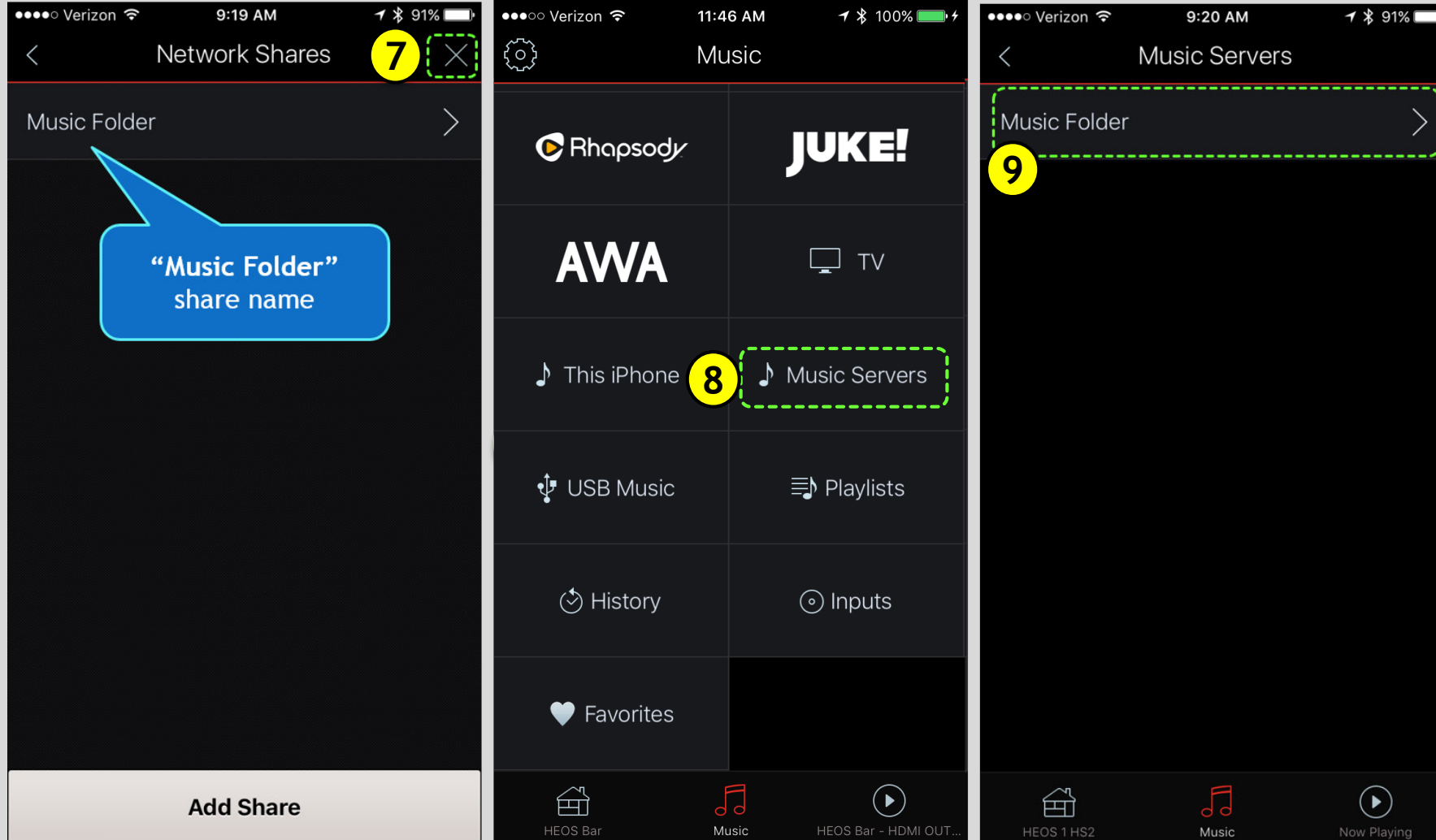

## HEOS App Network Shares Setup Procedure

### Procedure to access the “Network Shares” option setup:

10. Select “**Browse**” from the Music folder options.
11. Select “**Browse Folder**”.
12. After selecting “**Browse Folder**”, you will see the supported music files listed that are available to play on the HEOS device.

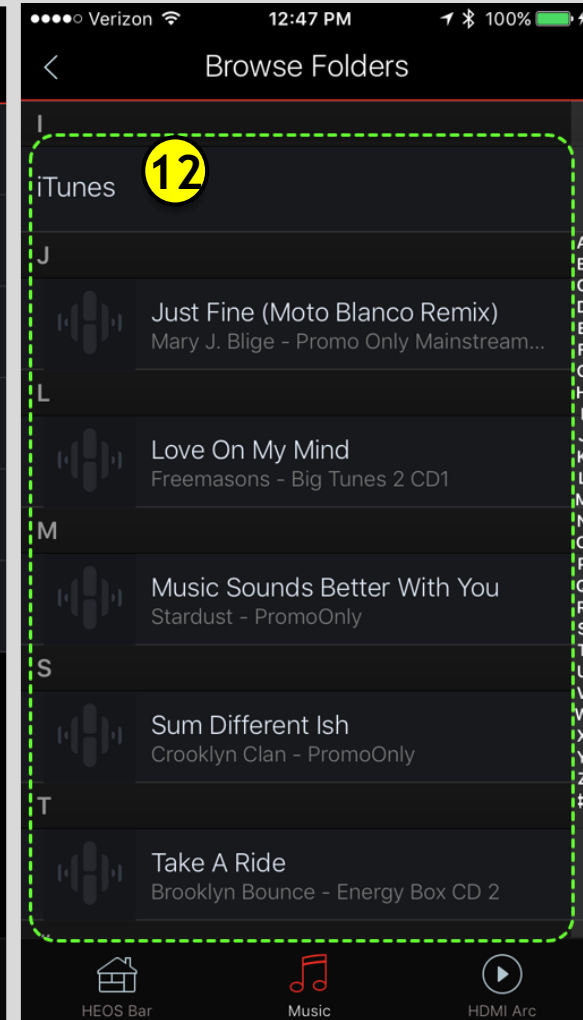
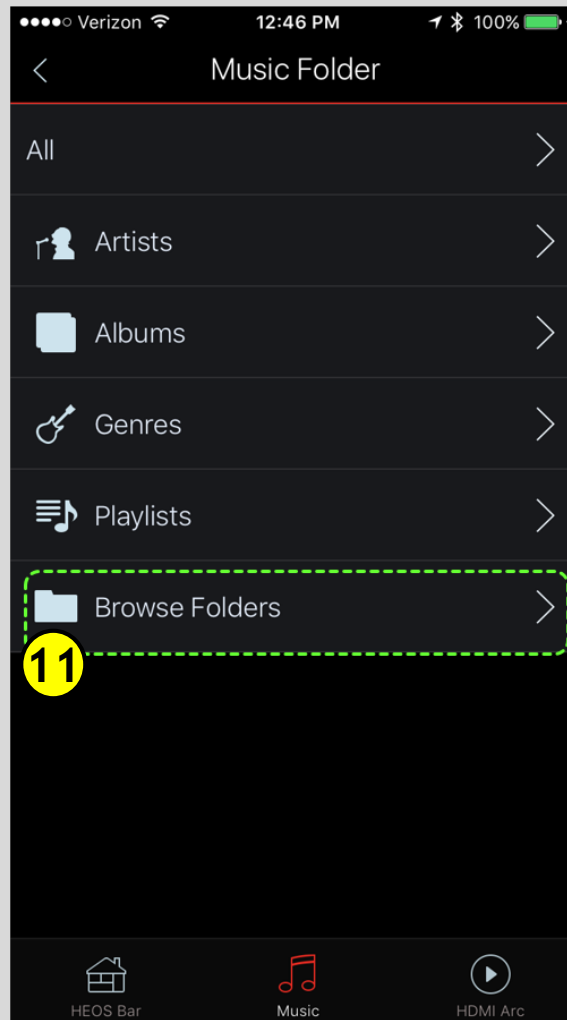
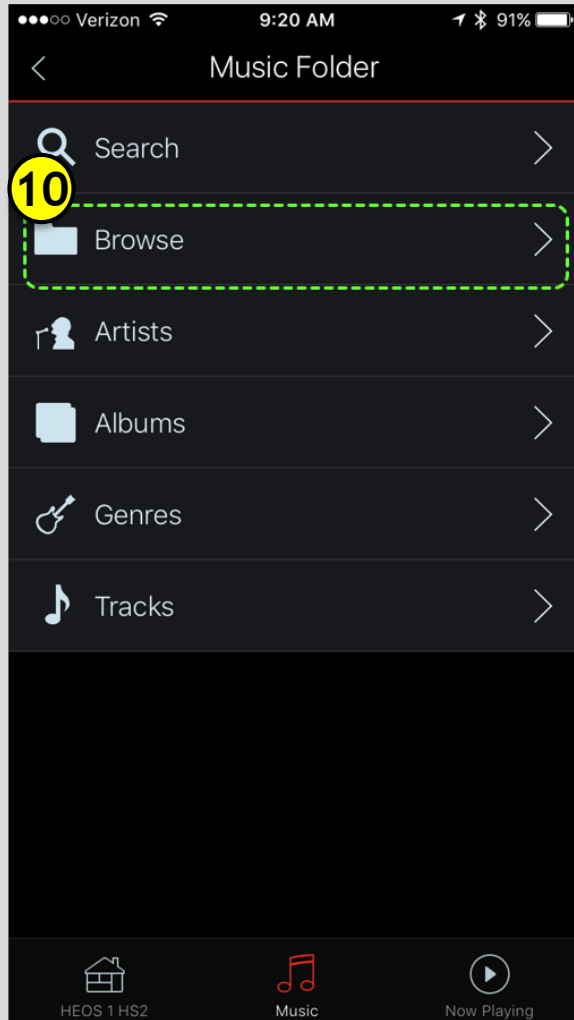

## HEOS App Network Shares Setup Procedure

### If the network share becomes inaccessible:

13. Go to Music > Settings > Music Sources > Network Shares > Select the share name (Steps 1, 2, 3,7) and tap “Connect”.

**a** - Make sure that “Status” shows “Connected (Indexed)”.

**b** - If the Status shows “Connected (Offline)”, please verify your shared network resource (such as the computer containing the music) is connected on the same network and powered on.

